

Industrial Inkjet Coding Printer Installation Manual



This instruction manual is applicable to the installation of the 0.5 inch and 1 inch inkjet coding printers.

Industrial InkJet Coding Printer Packing List

No.	Name	Unit	Single Head	Dual Head		Four Head				Remarks	
				Combined printheads	Separated printheads	Combined printheads*1	Combined dual printheads*2	Separated dual printheads	Separated four printheads		
1	Master controller	Dual printhead printer	set	1	1	—					
		Four-head printer	set	—	—	1					
		Master controller support block	piece	1	1	1					
		No.3 screw	piece	4	4	4					
2	USB flash disk	piece	1	1	1						
3	Ground wire	piece	2	2	2						
4	Wrench	piece	2	2	2				M4/M5		
5	Power adapter	piece	1	1	1						
6	HDMI cable	piece	1	2	4						
7	Installation Manual	piece	1	1	1						
8	Single head Module	Printhead module	set	1	—	2	—	—	4	4	
		No. 1 screw	set	6	—	12	—	—	12	24	
		Anti-shocking plate	piece	1	—	2	—	—	2	4	
9	Dual head Module	Printhead Module	set	—	1	—	—	4	4	—	
		No. 1 screw	set	—	7	—	—	14	14	—	
		Dual head anti-shocking plate	piece	—	1	—	—	2	1	—	
10	Four-head Module	Printhead Module	set	—	—	—	4	—	—	—	
		No. 1 screw	set	—	—	—	11	—	—	—	
		Four-head anti-shocking plate	piece	—	—	—	1	—	—	—	
11	Side printing Single head bracket set	D-shaft connection block	piece	3	3	5	—	—	—	—	
		Bottom limit block	piece	2	2	3	—	—	—	—	Pre-installed
		Aluminum screw nut	piece	1	1	2	—	—	—	—	
		No. 4 screw	piece	2	2	4	—	—	—	—	
		External photoelectric sensor fixing block	piece	9	9	14	—	—	—	—	Pre-installed
		D-shaft connection block	piece	1	1	1	—	—	—	—	
		No. 3 screw	piece	1	1	2	—	—	—	—	Pre-installed
D-shaped shaft	piece	8	8	8	—	—	—	—			
12	Side printing Multi-head bracket set	D-shaft connection block	piece	—	—	—	5	5	7	9	
		Bottom limit block	piece	—	—	—	3	3	4	5	Pre-installed
		Aluminum screw nut	piece	—	—	—	2	2	3	4	Pre-installed
		No. 4 screw	piece	—	—	—	4	4	6	8	
		External photoelectric sensor fixing block	piece	—	—	—	14	14	19	24	Pre-installed
		D shaft connection block	piece	—	—	—	1	1	1	1	Pre-installed
		No. 3 screw	piece	—	—	—	2	2	3	4	
D-shaped shaft	piece	—	—	—	4	4	6	8			
13	External photoelectric sensor module	set	1	1	1	1	1	1	1		

Standard Accessory Drawing

Master controller

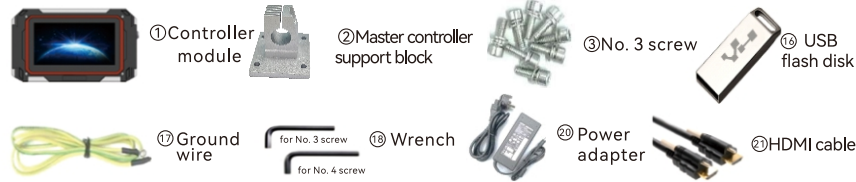

Single head Module

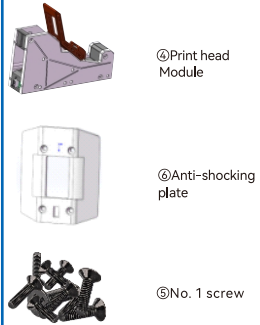

Dual head Module

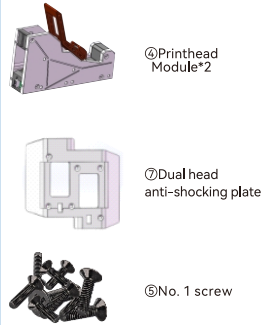

Four-head Module

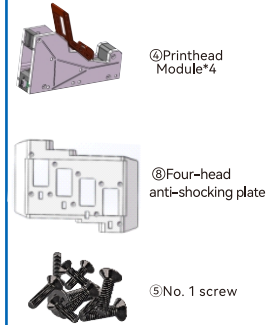

Side printing single head brackets set

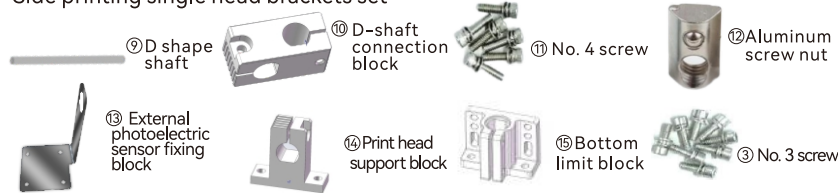

Side printing Multi-print heads module

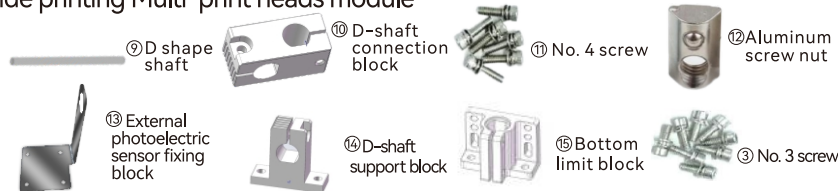

Optional Parts List

No.	Name	No.	Unit	Single Head	Dual Head	Four Head	Remarks
1	Ink cartridge	⑫	piece				Optional
2	Synchronous wheel module	⑳		More than two ends must be selected			
3	External photoelectric sensor module	㉔		Induction mode printing mandatory			
4	Anti-shock module	㉕					
5	Swivel module	㉖					
6	Fine-tuning module	㉗					
7	Bridge bracket module	㉘					
8	Fiber optic sensor	㉙					
9	Three-color beacon	㉚					
10	Assembly line floor support	㉛					
11	Floor support fixing bracket	㉜					
12	Single/dual head guide plate	㉝					
13	Four-head guide plate	㉞					

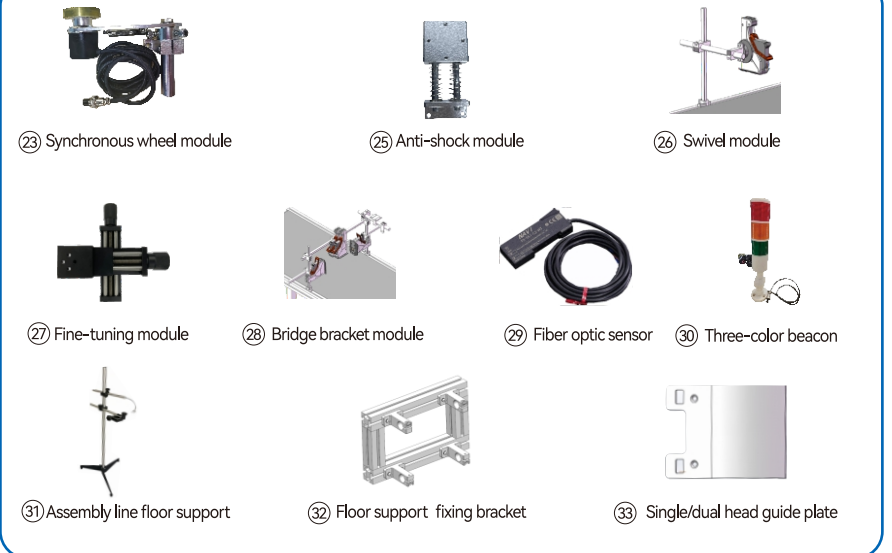

Master Controller

Master controller

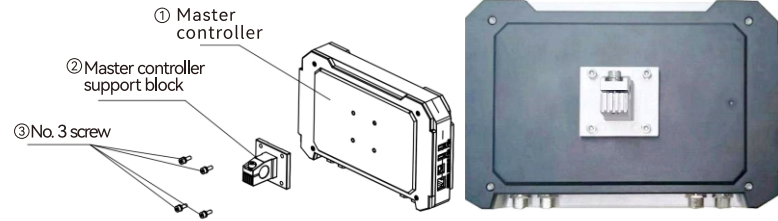

Note: Single and Dual head printers has only P1/P2 port and Four head printers has P1/P2/P3/P4 ports

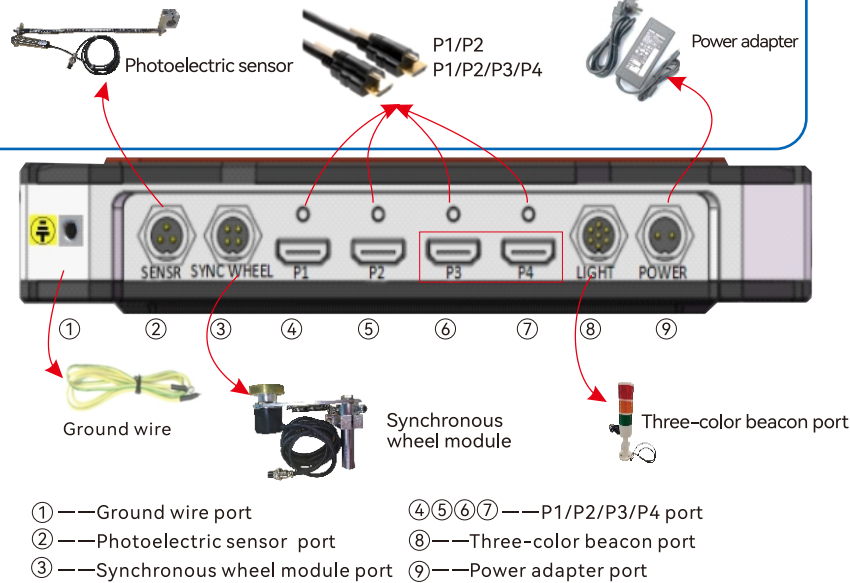

- ① --- Ground wire port
- ② --- Photoelectric sensor port
- ③ --- Synchronous wheel module port
- ④ ⑤ ⑥ ⑦ --- P1/P2/P3/P4 port
- ⑧ --- Three-color beacon port
- ⑨ --- Power adapter port

Note:

1. Connect the master controller and print head module via HDMI cables in sequence as marked as P1/P2/P3/P4, and fix them with screws.
2. Connect the photoelectric sensor, power adapter with the master controller. Synchronous wheel and three-color beacon are optional accessories, contact your dealer for purchase if needed.

Module Assembling

Single print head module assembling

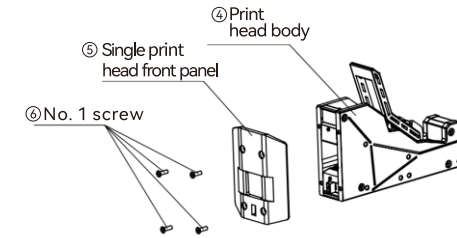
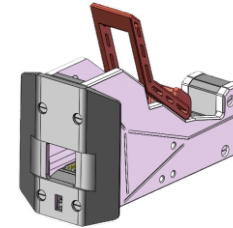

Dual print head module assembling

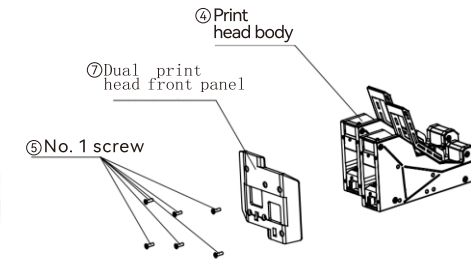
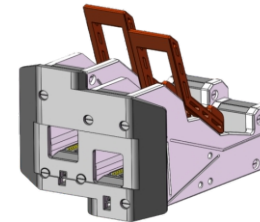

Four-print head module assembling

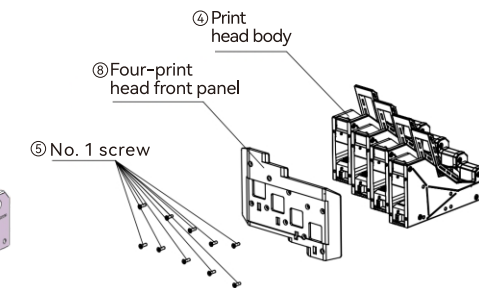
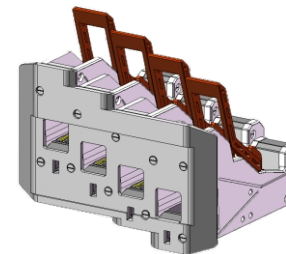

Note:

The front panel are marked with the number P1/P2/P3/P4 respectively. Assemble them accordingly.

Print Head Assembly

Ground wire assembling

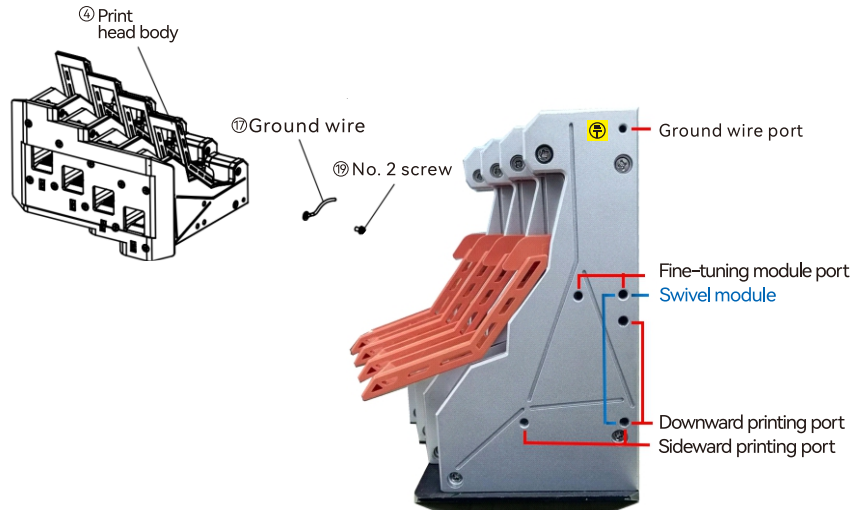

Print head support block assembling

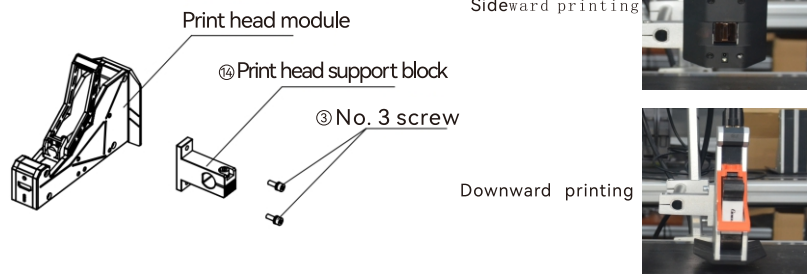

Note:

When installing the printhead(s), downward and sideward are optional based on your actual needs.

Bracket Module Assembling

Side printing single head bracket assembly

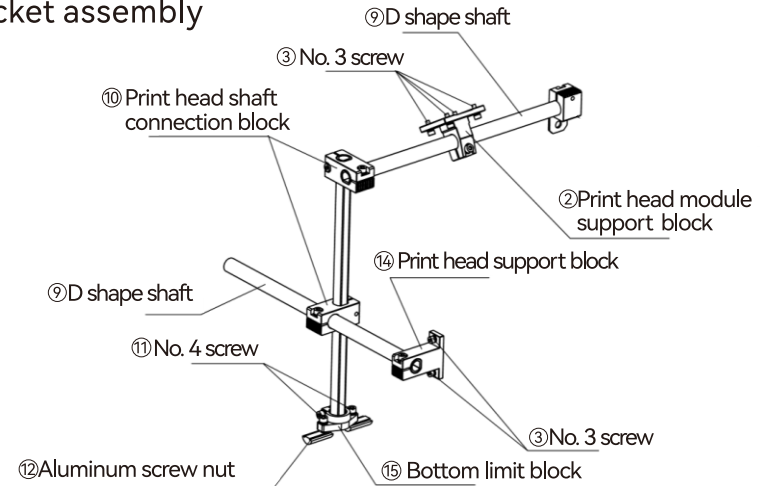

Side printing multiple printheads bracket assembly

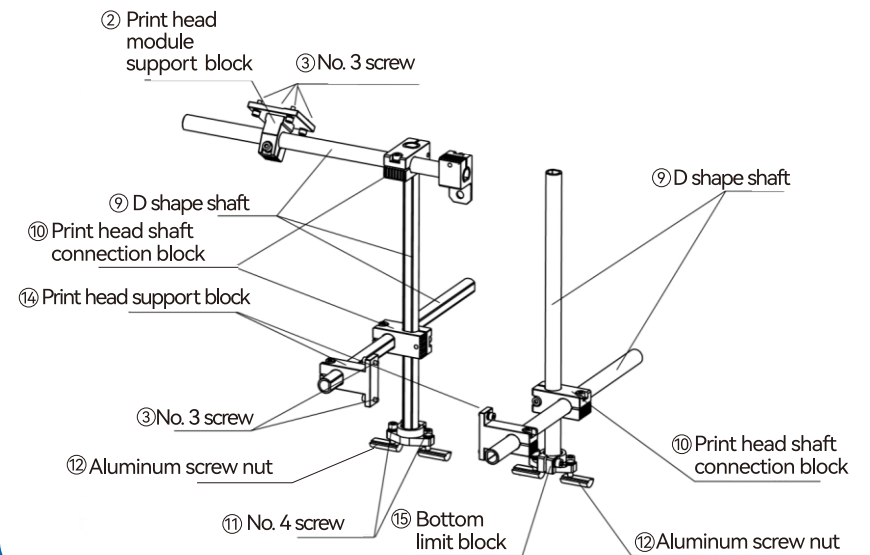

Modules Assembling

Synchronous wheel assembling

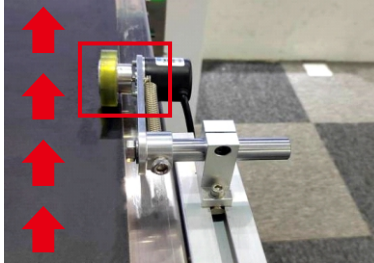

The synchronous wheel must be in close contact with the belt.

Photoelectric sensor assembling

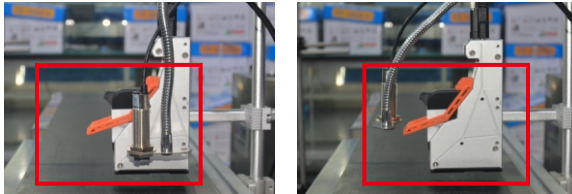

The distance between the photoelectric sensor and the printed object should be between 10mm and 200mm.

Print head assembling

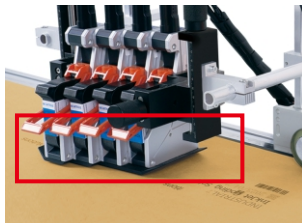

The required distance between print head Nozzles to print objects (Ink throw distance) is 2-5mm.

Single/Dual Head Printer Assembling Reference



Four- Head Printer Assembling Reference

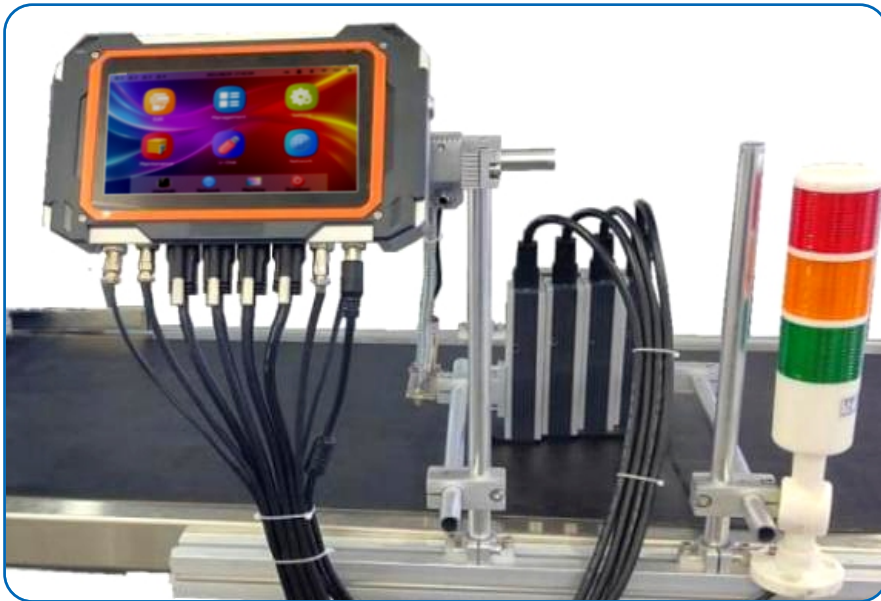

Important:

1. Do not connect or disconnect its cables when the machine is powered on.
2. Use the manufacturer's specified ink type of ink and accessories for best printing results. The use of non-specified ink and accessories may cause printer failure and poor printing, and will void the warranty.
3. Printer failures caused by operating without following this manual shall not be within the scope of product warranty.

Safety Instructions:

1. There would be high voltage inside the machine after the inkjet printer is powered on. Untrained and unauthorized personnel are not allowed to maintain or disassemble the equipment to avoid accidents.
2. Do not place the ink in direct sunlight or store it at high temperature (over 35°C), otherwise, the printing effect and shelf life of the ink will be affected.
3. If the ink accidentally splashes on the eyes or skin during use, rinse it off with clean water immediately and seek medical attention immediately.

Warranty Instructions

Dear customer

Thank you for purchasing Industrial Inkjet Printers! To ensure the safe use of the product and your benefits and interests, please read the following content carefully, fill in and properly keep the warranty card. This product is a precision instrument. In case of any abnormality, refer to this manual for troubleshooting or contact the customer service center of your seller.

Term of service

1. This product is with a one-year warranty period. The starting date of the warranty period is subject to the date of the product invoice.
2. During the warranty period, if the product is under normal use and maintenance and failure is caused by the quality of the machine itself, the company will provide free repair and replacement parts.
3. Vulnerable parts are excluded, such as ink cartridges, screens, removable storage, switches, chargers, batteries, which shall not be covered by the warranty.

Disclaimer

Any of the following conditions shall not be covered by the warranty:

1. Damage due to improper transportation, use, storage, and maintenance, or man-made damage.
2. Unauthorized repair or the user installs, disassembles, and repairs the machine by himself.
3. Damages caused by using non-genuine consumables or accessories which are not provided by the company.
4. Missed or modified warranty card.
5. Beyond the warranty period.
6. Damage caused by force majeure.

Warranty Card

Product related information

Customer name:	Contact phone:
Mailing address:	
Product model:	Product ID:
Store purchased:	Purchase date:
Maintenance store:	Invoice No.:

Maintenance record

Date of maintenance:		
Failure description:		
Solution:		
Maintained by:	Contact phone:	Staff signature:

Fill in this warranty card in time after purchasing this printer.
Please keep the warranty card properly, and it is not required to send it back to the seller.
Carry the warranty card and the original invoice for maintenance.